

# MODULAR COLDROOMS

## Tehma



Tehma



# MODERN REFRIGERATORS



Tehma





Tehma

## A QUICK AND CONVENIENT SOLUTION

### Convenient transportation

The panels are light due to the structure - filling of Polyurethane foam

Does not require special equipment for loading and unloading operations

### Easy assembly and disassembly

It is assembled quickly - like a constructor, in 3 hours

2 people and ordinary tools are enough

Designed for repeated assembly - disassembly

### Universal solution

Medium-temperature and low-temperature rooms

A wide selection of sizes

# SPECIFICATIONS



# Tehma

Body material	PPU sandwich panels (polyurethane foam 40-42 kg/m <sup>3</sup> )
Floor material	Sandwich panels covered with bakelite plywood
Facing material	Galvanized steel
Cladding color	White (RAL 9003)
Panel thickness	80, 100 mm
Temperature mode	-20 ... +5 C
Internal dimensions: Length Depth Height	1500 – 6900 mm 1500 – 3000 mm 2000 / 2200 mm
External dimensions	+160, 200 mm to the side
Equipment	<ul style="list-style-type: none"><li>Refrigerator door unit standard (for a medium-temperature chamber, -5+5C)/ Refrigerator door block standard + tan (for low-temperature chamber, -18-20C)</li></ul>
Additional equipment	Additionally, it is possible to equip lighting (lamp, cable, cable channel, switch)

\* If a large order is placed, it is possible to manufacture in the desired color, according to the RAL scale

# MONOBLOCKS FOR COLDROOMS



# Tehma

Model	Cold production	Dimensions
Medium temperature	W	mm
TSM8NE	760	955x545x870
TSM10NE	1694	1055x655x870
TSM20NE	3160	1055x855x870
Low temperature		
TSL19NE	3300	1020x1135x870





# OVERALL DIMENSIONS OF CAMERAS



Tehma

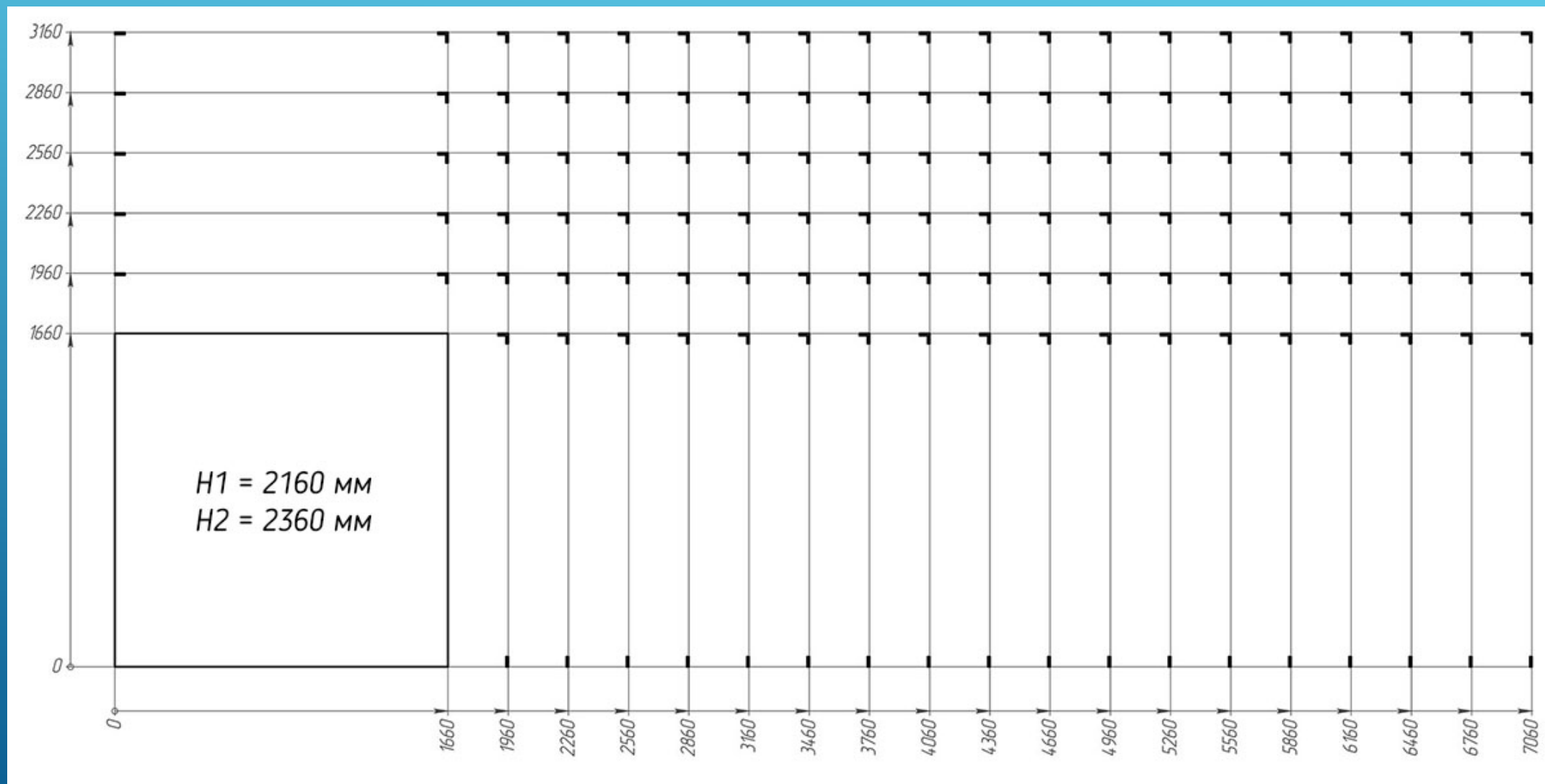



Tehma

# THE SCHEME OF THE COLLAPSIBLE CHAMBER

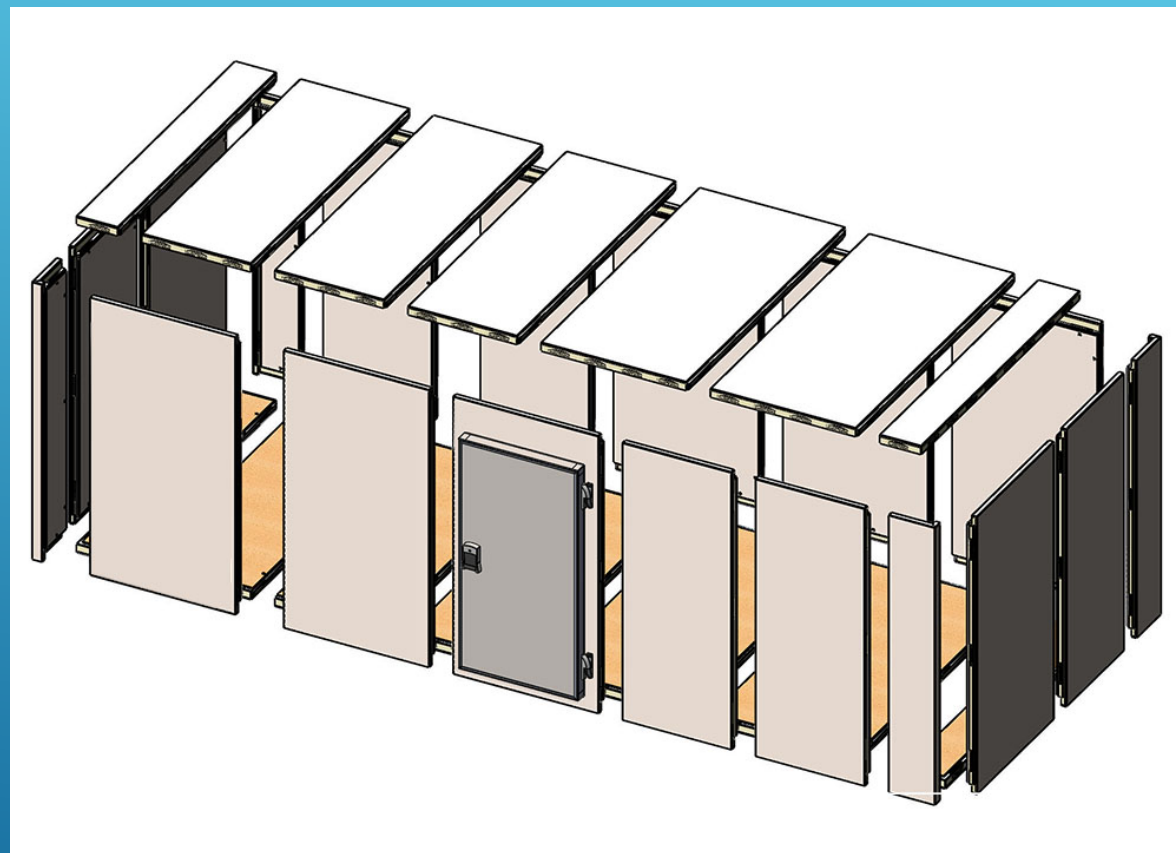
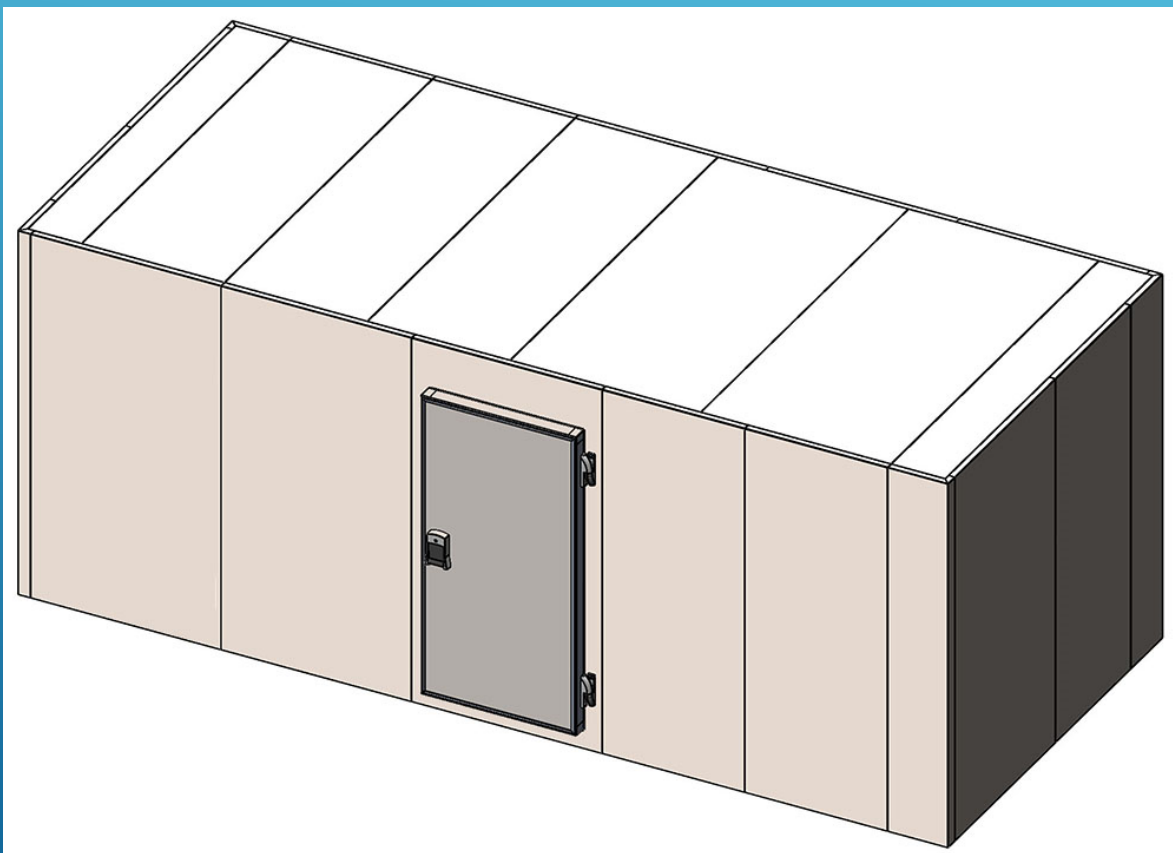



# Tehma

## BUILD SEQUENCE

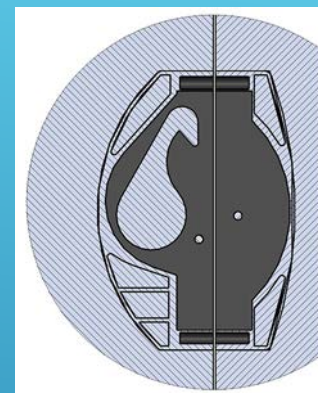

Panels are connected using eccentric locks. A simple hex key is enough for this.

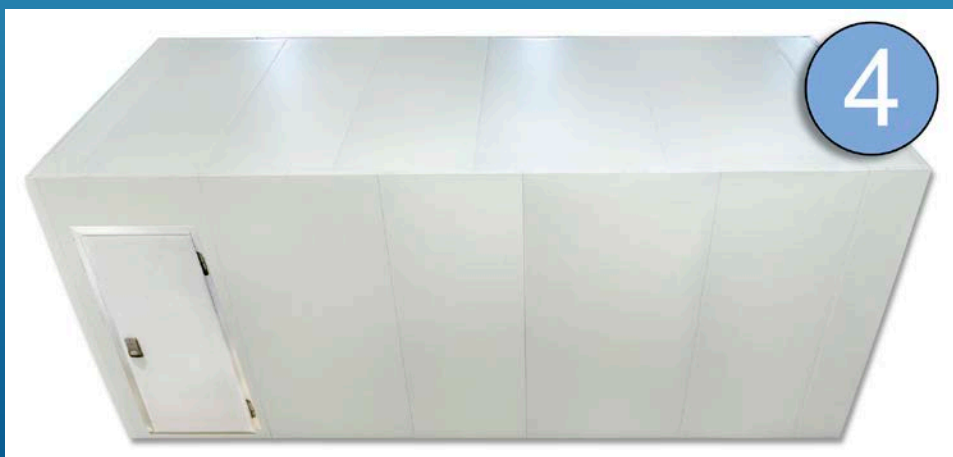

1. Assembly and laying of floor panels Installation of the first corners of the refrigerating chamber
2. Assembly of walls
3. Assembly of the last corners of the module
4. Assembly of ceiling panels and door module.